

**Installation:** hazardous areas - Zone 1 / 2 (Gases) - Zone 21 / 22 (Dusts)**Classification:** Group II - Category 2G 2D**REFERENCE STANDARDS****Directive 2014/34/EU**

EXECUTION	⊗ II 2 G Ex d IIC Gb ⊗ II 2 D Ex tb IIIC Db
RULES OF COMPLIANCE	EN/IEC 60079-0; EN/IEC 60079-1; EN/IEC 61241-0; EN/IEC 61241-1
EC Type-Examination Certificate	ICEPI 11 ATEX 03C002 (sealing fittings) INERIS 12 ATEX 0069X (three pieces union)
PROTECTION DEGREE	IP66 (sealing fittings) IP66/IP67 (three pieces union)
AMBIENT TEMPERATURE	-20°C ÷ +60°C
OTHER AVAILABLE CERTIFICATES	IECEx: IECEx INE 12.0051X (three pieces union)  INMETRO: CEPEL 13.2243U (three pieces union)  EAC: TC RU C-IT.BH02.B.00587 (-60°C ÷ +80°C)  RUSSIAN MARINE CERTIFICATE (RMRS): 19.02521.280  UL NEC-505: 20131204-E465038 (three pieces union)

**SEALING FITTINGS - Mechanical characteristics**

Material	marine grade copper free aluminum light alloy
----------	---

**THREE PIECE UNIONS - Mechanical characteristics**

Material	galvanized steel
Gasket	silicon rubber EPDM

**On Request Accessories:**

- Different threads from standard
- Different materials from standard

## Technical Features

DETAIL "A"	DETAIL "B"	DETAIL "C"	ØD HUBS (UN16125 OR NPT)
TYPE	TYPE	TYPE	
EYS1	EZS1	EZD1	1/2"
EYS2	EZS2	EZD2	3/4"
EYS3	EZS3	EZD3	1"
-	EZS5	EZD5	1-1/2"
-	EZS6	EZD6	2"
-	EZS7	EZD7	2-1/2"
-	EZS8	EZD8	3"

## Sealing compound table

SIZE	EYS	EZS - EZD
	QUANTITY [gr]	QUANTITY [gr]
1	35	140
2	50	140
3	100	140
5	-	390
6	-	570
7	-	1000
8	-	1000

SEALING FITTINGS TO BE SEALED BY MEANS OF CRV-420 BI-COMPONENT SEALING COMPOUND PLEASE REFER TO SEALING TABLE FOR QUANTITIES.

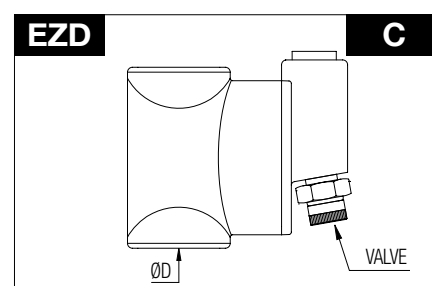
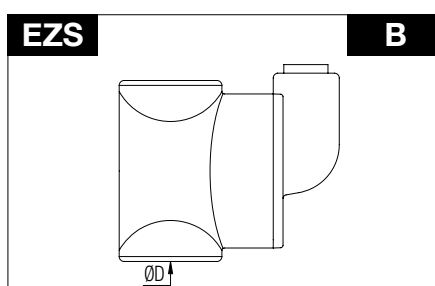
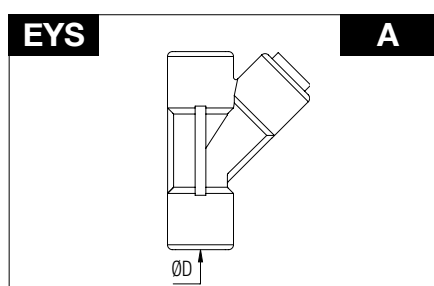

## THREE PIECES UNION - Technical Features

THREE PIECE UNION MALE/FEMALE Ex d IIC		
TYPE	ØD	DETAIL
RMF1	1/2"	D
RMF2	3/4"	D
RMF3	1"	D
RMF4	1-1/4"	D
RMF5	1-1/2"	D
RMF6	2"	D
RMF7	2-1/2"	D
RMF8	3"	D

THREE PIECE UNION MALE/MALE Ex d IIC		
TYPE	ØD	DETAIL
RMM1	1/2"	D
RMM2	3/4"	D
RMM3	1"	D
RMM4	1-1/4"	D
RMM5	1-1/2"	D
RMM6	2"	D
RMM7	2-1/2"	D
RMM8	3"	D

THREE PIECE UNION FEMALE/FEMALE Ex d IIC		
TYPE	ØD	DETAIL
RFF1	1/2"	E
RFF2	3/4"	E
RFF3	1"	E
RFF4	1-1/4"	E
RFF5	1-1/2"	E
RFF6	2"	E
RFF7	2-1/2"	E
RFF8	3"	E

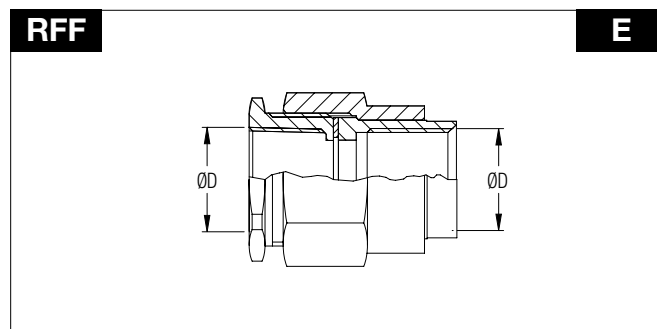
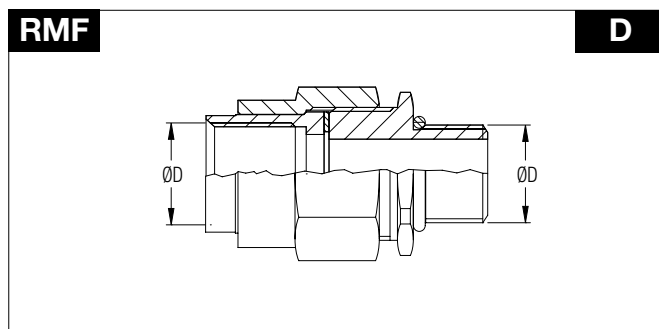

## REMARK:

Due to the development of the national and international specifications and of the technology, the above technical characteristics showed on this bulletin can be considered as binding on our confirmation only.

**Installation:** hazardous areas - Zone 1 / 2 (Gases) - Zone 21 / 22 (Dusts)**Classification:** Group II - Category 2G 2D**REFERENCE STANDARDS****Directive 2014/34/EU**

EXECUTION	⊗ II 2 G Ex db IIC Gb
	⊗ II 2 G Ex eb IIC Gb
	⊗ II 2 D Ex tb IIC Db
RULES OF COMPLIANCE	EN/IEC 60079-0; EN/IEC 60079-1; EN/IEC 60079-7; EN/IEC 60079-31
EC Type-Examination Certificate	INERIS 16 ATEX 0007X
PROTECTION DEGREE	IP66
AMBIENT TEMPERATURE	-60°C ÷ +130°C
OTHER AVAILABLE CERTIFICATES	IECEX: IECEX INE 16.0014X
	INMETRO: CEPEL 13.2223U
	EAC: TC RU C-IT.BH02.B.00587
	RINA: ELE18111CS_015
	RUSSIAN MARINE CERTIFICATE (RMRS): 19.02521.280
	UL NEC-505: 20131204-E465038 CCOE-PESO: P413653/1

**Mechanical characteristics**

Reducers materials	galvanized steel (AZ)
Adaptors materials	OT-58 marine brass (OT) - nichel plated brass (ON) - AISI-316L stainless steel (IX) - galvanized steel (AZ)
Finishes	full nickel plating threatment (brass material only)
Gasket	silicon rubber EPDM / NYLON

**Applications**

EXPLOSION PROOF REDUCER AND ADAPTORS ARE USED TO CONNECT VARIOUS EQUIPMENT: ENCLOSURES, LIGHTING FIXTURES, JUNCTION AND PULLING BOXES ECT. OF DIFFERENT DIAMETERS AND THREADS

**On Request Accessories:**

- Different threads from standard
- Different materials from standard
- Silicon Rubber Gaskets

## REDUCERS - Technical Features

RING REDUCERS - RE				REDUCERS BUSHING - REB				REDUCERS COUPLING - REM				REDUCERS NIPPLE - REN			
TYPE	ØA MALE	ØB FEMALE	DET.	TYPE	ØA MALE	ØB FEMALE	DET.	TYPE	ØA FEMALE	ØA FEMALE	DET.	TYPE	ØA MALE	ØA MALE	DET.
RE21	3/4"	1/2"	A	REB21	1/2"	3/4"	B	REM21	3/4"	1/2"	C	REN21	3/4"	1/2"	D
RE31	1"	1/2"	A	REB31	1/2"	1"	B	REM31	1"	1/2"	C	REN31	1"	1/2"	D
RE32	1"	3/4"	A	REB32	3/4"	1"	B	REM32	1"	3/4"	C	REN32	1"	3/4"	D
RE41	1-1/4"	1/2"	A	REB41	1/2"	1-1/4"	B	REM41	1-1/4"	1/2"	C	REN41	1-1/4"	1/2"	D
RE42	1-1/4"	3/4"	A	REB42	3/4"	1-1/4"	B	REM42	1-1/4"	3/4"	C	REN42	1-1/4"	3/4"	D
RE43	1-1/4"	1"	A	REB43	1"	1-1/4"	B	REM43	1-1/4"	1"	C	REN43	1-1/4"	1"	D
RE51	1-1/2"	1/2"	A	REB51	1/2"	1-1/2"	B	REM51	1-1/2"	1/2"	C	REN51	1-1/2"	1/2"	D
RE52	1-1/2"	3/4"	A	REB52	3/4"	1-1/2"	B	REM52	1-1/2"	3/4"	C	REN52	1-1/2"	3/4"	D
RE53	1-1/2"	1"	A	REB53	1"	1-1/2"	B	REM53	1-1/2"	1"	C	REN53	1-1/2"	1"	D
RE54	1-1/2"	1-1/4"	A	REB54	1-1/4"	1-1/2"	B	REM54	1-1/2"	1-1/4"	C	REN54	1-1/2"	1-1/4"	D
RE61	2"	1/2"	A	REB61	1/2"	2"	B	REM61	2"	1/2"	C	REN61	2"	1/2"	D
RE62	2"	3/4"	A	REB62	3/4"	2"	B	REM62	2"	3/4"	C	REN62	2"	3/4"	D
RE63	2"	1"	A	REB63	1"	2"	B	REM63	2"	1"	C	REN63	2"	1"	D
RE64	2"	1-1/4"	A	REB64	1-1/4"	2"	B	REM64	2"	1-1/4"	C	REN64	2"	1-1/4"	D
RE65	2"	1-1/2"	A	REB65	1-1/2"	2"	B	REM65	2"	1-1/2"	C	REN65	2"	1-1/2"	D
RE71	2-1/2"	1/2"	A	REB71	1/2"	2-1/2"	B	REM71	2-1/2"	1/2"	C	REN71	2-1/2"	1/2"	D
RE72	2-1/2"	3/4"	A	REB72	3/4"	2-1/2"	B	REM72	2-1/2"	3/4"	C	REN72	2-1/2"	3/4"	D
RE73	2-1/2"	1"	A	REB73	1"	2-1/2"	B	REM73	2-1/2"	1"	C	REN73	2-1/2"	1"	D
RE74	2-1/2"	1-1/4"	A	REB74	1-1/4"	2-1/2"	B	REM74	2-1/2"	1-1/4"	C	REN74	2-1/2"	1-1/4"	D
RE75	2-1/2"	1-1/2"	A	REB75	1-1/2"	2-1/2"	B	REM75	2-1/2"	1-1/2"	C	REN75	2-1/2"	1-1/2"	D
RE76	2-1/2"	2"	A	REB76	2"	2-1/2"	B	REM76	2-1/2"	2"	C	REN76	2-1/2"	2"	D
RE81	3"	1/2"	A	REB81	1/2"	3"	B	REM81	3"	1/2"	C	REN81	3"	1/2"	D
RE82	3"	3/4"	A	REB82	3/4"	3"	B	REM82	3"	3/4"	C	REN82	3"	3/4"	D
RE83	3"	1"	A	REB83	1"	3"	B	REM83	3"	1"	C	REN83	3"	1"	D
RE84	3"	1-1/4"	A	REB84	1-1/4"	3"	B	REM84	3"	1-1/4"	C	REN84	3"	1-1/4"	D
RE85	3"	1-1/2"	A	REB85	1-1/2"	3"	B	REM85	3"	1-1/2"	C	REN85	3"	1-1/2"	D
RE86	3"	2"	A	REB86	2"	3"	B	REM86	3"	2"	C	REN86	3"	2"	D
RE87	3"	2-1/2"	A	REB87	2-1/2"	3"	B	REM87	3"	2-1/2"	C	REN87	3"	2-1/2"	D

New available sizes on demand: 3-1/2" - 4" - 5" - 6"

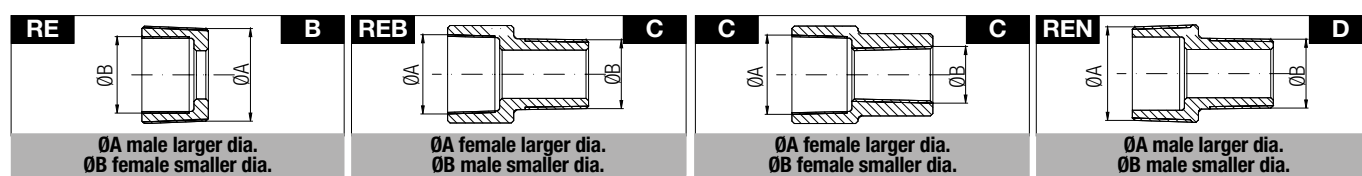

## Identification adaptors selection table

SIZE LARGER DIAMETER	
02 / 03 / 04 / 05 / 06 / 06 / 07 / 08	
LARGER DIA. TYPE OF THREAD	
R-Rc (EN 10226-2), P(PG), N (NPT), G (ISO 228), M (ISO-metric)	
SIZE SMALLER DIAMETER	
01 / 02 / 03 / 04 / 05 / 06 / 06 / 07	
SMALLER DIA. TYPE OF THREAD	
R-Rc (EN 10226-2), P(PG), N (NPT), G (ISO 228), M (ISO-metric)	
MATERIAL	
IX (stainless steel), ON (nikel plated brass), OT (marine brass)	

	TYPE	SIZE LARGER DIAMETER	THREAD	SIZE SMALLER DIAMETER	THREAD	MATERIAL
EXAMPLE 1	RE	02	R-Rc	01	G	ON
EXAMPLE 2	REB	03	N	-	M40	IX

EXAMPLE 1: RE02K01GON= REDUCER TYPE RE MALE 3/4" 6125 - FEMALE 1/2" ISO228 NIKEL PLATED BRASS

EXAMPLE 2: REB03NM40IX= REDUCER TYPE REB MALE 1"NPT - FEMALE M40 STAINLESS STEEL

## REMARK:

Due to the development of the national and international specifications and of the technology, the above technical characteristics showed on this bulletin can be considered as binding on our confirmation only.